



April 2016 - Revision B  
**Quick Coupling Division**  
 8145 Lewis Road  
 Minneapolis, MN 55427  
 phone 763 544 7781  
 fax 763 544 3418

# SUBSEA COUPLING SOLUTIONS

## DSF Series Data Sheet

DSF Series poppet style couplings are self-aligning allowing rigid mounting of both the male and female. High operating pressures and robust construction make them ideal for the most challenging subsea applications.



### Features:

- Sizes 1/8" - 3/8"
- Up to 25,000 psi (1725 bar)
- Poppet valves
- PEEK primary seals
- Parker Nitrile O-rings standard
- Body material: 316 SST, Nitronic® 60, Inconel and Nickel Cobalt MP35N
- Internal component materials: 302, 316 SST and Inconel

### Options:

- Various O-ring materials
- End configurations: Cartridge, Autoclave, Compression (others available upon request)

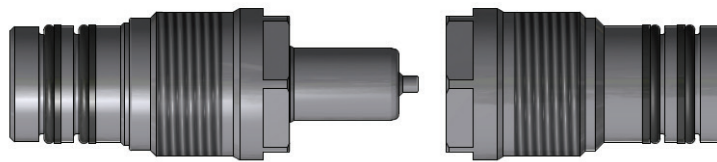

Size	Working Pressure*** (psi/bar)	Rated Working Depth** (ft/m)	Cv per Coupling Half	Separation Force (lb/1000 psi & N/100 bar)	Water Ingress Per Connect (ml)	Length* (in/mm)	Largest Diameter* (in/mm)
1/8"	25,000/1725	10,000/3050	0.4	192/1242	1.1	Male: 2.80/71.1	1.04/26.4
						Female: 1.93/49.0	
3/8"	5000/345	10,000/3050	1.7	438/2828	3.0	Male: 3.61/91.7	1.50/38.1
						Female: 2.55/64.8	

Data given is representative of the coupling series. Individual couplings may vary based on specific configuration of fittings/optional features.

\* Largest diameter and length are for reference. May change for a specific plate configuration.

\*\* Mate/demate rated depth of 6560ft/2000m.

\*\*\* Max pressure rating dependent on end configuration.